



BARTELL MORRISON INC. 375 Annagem Blvd., Mississauga, ON L5T 3A7
Telephone: 1-647-953-4100 Fax: 1-647-953-4101

ELECTRIC GENERATORS

BG2800, BG5000, BG7000E

OWNER'S MANUAL



Discount Equipment

Discount-Equipment.com is your online resource for commercial and industrial quality parts and equipment sales.

Locations:

Florida (West Palm Beach): [561-964-4949](tel:561-964-4949)

Outside Florida TOLL FREE: [877-690-3101](tel:877-690-3101)

Need parts? Check out our website at www.discount-equipment.com

Can't find what you need?

Click on this link: <http://www.discount-equipment.com/category/5443-parts/> and fill out the request form.

Please have the machine model and serial number available in order to help us get you the correct parts. One of our experienced staff members will get back to you with a quote for the right part that your machine needs.

We sell worldwide for the brands: Genie, Terex, JLG, MultiQuip, Mayco, Toro/Stone, Diamond Products, Magnum, Airman, Mustang, Power Blanket, Nifty Lift, Atlas Copco, Chicago Pneumatic, Allmand Brothers, Essick, Miller Spreader, Skyjack, Lull, Skytrak, Tsurumi, Husquvarna/Target, Whiteman-Concrete/Mortar, Stow-Concrete/Mortar, Baldor, Wacker, Sakai, Snorkel, Upright, Mi-T-M, Sullair, Neal, Basic, Dynapac, MBW, Weber, Bartell, Bennar Newman, Haulotte, Ditch Runner, Blaw-Knox, Himoina, Best, Buddy, Crown, Edco, Wyco, Bomag, Laymor, Terremite, Barreto, EZ Trench, Takeuchi, Basic, Bil-Jax, Curtis, Gehl, Heli, Honda, ICS/PowerGrit, Puckett, Waldon, ASV, IHI, Partner, Imer, Clipper, MMD, Koshin, Rice, Gorman Rupp, CH&E, Cat Pumps, Comet, General Pump, Giant, AMida, Coleman, NAC, Gradall, Square Shooter, Kent, Stanley, Tamco, Toku, Hatz, Kohler, Robin, Wisconsin, Northrock, Oztec, Toker TK, Rol-Air, Small Line, Wanco, Yanmar

SAFETY PRECAUTIONS

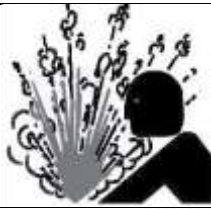

DANGER

EXPLOSION HAZARD

Never operate the machine in an explosive atmosphere, near combustible materials, or where ventilation does not clear exhaust fumes.



WARNING

BURN HAZARD

Never come into contact with the engine or muffler when engine is operating or shortly after it is turned off. Serious burns may occur.



CAUTION

ROTATING HAZARD

Never place hands or feet inside safety guard rings. Serious injury will result from contact with rotating blades.



CAUTION

MOVING PARTS

Before starting the machine, ensure that all guards and safety devices are in place and functioning properly.



ATTENTION

READ OWNER'S MANUAL

Read and understand owner's manual before using this machine. Failure to follow operating instructions could result in serious injury or death.

TABLE OF CONTENTS

<u>WARRANTY INFORMATION - GENERATORS</u>	5
<u>INTRODUCTION - BG2800, BG5000, BG7000E</u>	6
YOUR NEW BARTELL ELECTRIC GENERATOR	6
EQUIPMENT USE AND CARE	6
SAFETY FEATURES	6
<u>SPECIFICATIONS - BG2800, BG5000, BG7000E</u>	7
<u>SAFETY - BG2800, BG5000, BG7000E</u>	8
SAFETY	9
<u>PARTS AND COMPONENTS INTRODUCTION - BG2800, BG5000, BG7000E</u>	10
<u>INSPECTION - BG2800, BG5000, BG7000E</u>	11
ENGINE OIL	11
FUEL	11
AIR CLEANER	11
<u>STARTING THE GENERATOR - BG2800, BG5000, BG7000E</u>	12
<u>STOPPING THE GENERATOR - BG2800, BG5000, BG7000E</u>	12
<u>ELECTRICAL CONNECTIONS - BG2800, BG5000, BG7000E</u>	13
GENERATOR GROUNDING	13
TYPICAL ELECTRICAL CONSUMPTION	13
APPLIANCE START UP	13
AC APPLICATION	14
DC APPLICATION	14
<u>REGULAR INSPECTION AND MAINTENANCE - BG2800, BG5000, BG7000E</u>	15
ENGINE OIL REPLACEMENT	15
SPARK PLUG CLEANING	15
<u>STORAGE - BG2800, BG5000, BG7000E</u>	16
STORAGE PREPARATION	16
CLEANING	16
FUEL	16
DRAINING THE FUEL TANK AND CARBURETOR	17
ENGINE OIL	17
STORAGE PRECAUTIONS	17
REMOVAL FROM STORAGE	17

TROUBLESHOOTING BG2800, BG5000, BG7000E	18
STARTING FAILURE	18
APPLIANCE DOES NOT WORK	18
ELECTRICAL DIAGRAMS	19
BG2800	19
BG5000	20
BG7000E	21
ASSEMBLY DRAWINGS AND PARTS LIST	22
ENGINE AND ALTERNATOR	23
FRAME, MUFFLER, FUEL TANK AND AIR CLEANER	24
CONTROL PANELS	25
PARTS LIST	26

Discount-Equipment.com

WARRANTY INFORMATION - GENERATORS

All products sold by Bartell Morrison Inc. and Bartell Morrison (USA) LLC (the "Company") are warranted against defects in materials and/or workmanship; excluding normal wear on wearing components and components covered by a separate original manufacturer's warranty, for a period of 12 months (from the date of sale to the original end user purchaser provided that certain conditions have been met.

Conditions

1. The equipment serial number has been registered with the Company or its approved dealers, distributors, representatives, or agents.
2. The equipment has been operated in an appropriate manner by qualified individuals.
3. The equipment has been properly maintained as per the instructions included in the Owner's Manual.
4. All claims for warranty must be filed on proper forms and include the serial number of the equipment along with proof of purchase.

Any evidence of failure to meet these conditions may result in a denial of the warranty claim.

Consideration of warranty claims will be at the sole discretion of the Company, or its authorized dealers, distributors, representatives, or agents.

The Company may, at its discretion, request that the equipment to be considered for warranty be returned at the owner's expense to an authorized repair facility for inspection.

Under this warranty, we may, at our discretion, repair or replace a part or the whole of the defective component or equipment.

Our Warranty coverage is limited to the cost to repair or replace the defective portion of the equipment and a reasonable (as determined by the Company) amount of labor to conduct the repair or replacement. Under no circumstances shall the Company be liable for any additional or exceptional costs beyond the cost to repair or replace the defective portion of the equipment. The Company shall not be held accountable for; costs associated with travel to inspect or repair defective equipment, costs for transporting defective equipment to or from an authorized repair facility, costs incurred to repair or replace the defective equipment at any facility other than one authorized by the Company or ancillary damage caused by or as a result of the defective equipment.

Under no circumstances shall equipment be returned to the Company or its authorized dealers, distributors, representatives, or agents without the approval of the Company as evidenced by a Returned Goods Number. To obtain a Returned Goods Number contact the factory or your authorized dealer, distributor, representative or agent.

This warranty is for the sole benefit of the original end user purchaser and is not transferable to any other company or person.

Introduction - BG2800, BG5000, BG7000E

Your New Bartell Electric Generator

The machines are portable Bartell Electric Generators powered by a four-stroke gasoline engine with 120V, 120/240VAC (except BG2800), 60Hz and 12VDC output. The Bartell Electric generators are suitable as temporary power supply. They have been designed to meet ETL safety standards and current EPA air quality regulations.

Equipment Use and Care

Bartell Electric Generator is designed for use as a portable temporary power supply. It should be operated always in accordance with the instructions detailed in this manual: Use of this equipment for any purpose other than that stated within creates the risk of personal injury and/or property damage.

Any modifications to the equipment must be performed by the manufacturer or an authorized dealer and must be authorized in advance by the manufacturer.

The equipment should be serviced, cleaned, and stored as detailed by this manual. Failure to follow these guidelines may result in the warranty being void. The manufacturer of this equipment cannot be held responsible for any damages resulting from misuse, abuse, or neglect.

Safety Features

Bartell Electric Generators are equipped with safety guards and electrical protection in accordance with North American and International standards.

Never attempt to disable or circumvent these safety devices. They are present for the operator's protection and any tampering will result in substantial risk to the operator and all present in the vicinity. If the generator's safety devices have been tampered with, do not use the equipment. Immediately contact your sales representative to obtain replacement parts or return the generator to your dealer for repairs.

Specifications - BG2800, BG5000, BG7000E

Generators			
	BG2800	BG5000	BG7000E
Frequency (Hz)	60	60	60
Rated Output (W)	2500	4500	6500
Max Output (W)	2800	5000	7000
Rated Current (A)	20.8	37.5/18.8	54.2/27.1
Voltage (V)	120	120/240	120/240
Engine			
DC Output(V)	12	12	12
Engine Model	LT210	LT420	LT420
Displacement cu. in. (cc)	12.7 (208)	25.6 (420)	25.6 (420)
Engine Speed (rpm)	3600	3600	3600
Continuous Output hp. (kW)	7 (5.2)	16 (11.8)	16 (11.8)
Starting System	Recoil	Recoil	Recoil/Electric
Unit			
Oil Capacity gal. (L)	0.16 (0.6)	0.37 (1.4)	0.37 (1.4)
Fuel Tank Capacity gal. (L)	3.96 (15)	6.6 (25)	6.6 (25)
Dimension L x W x H in. (mm)	25.6x18x18.9 (650x458x480)	29.3x21x23.2 (745x535x590)	29.3x21x23.2 (745x535x590)
Net Weight Lb. (Kg)	99 (45)	172 (78)	194 (88)

Safety - BG2800, BG5000, BG7000E

The instructions provided in this manual are done so to ensure the operator's safety as well as that of others, the equipment, and the job site. Failure to abide by these guidelines can lead to serious personal injury and even death. The operator and any service personnel should read and understand the entire manual before working with or servicing any Bartell Electric Generator.

The Electric Generator manual should always be kept in a place that is accessible to any persons working with the machine. Replacement manuals are available from Bartell or from your local dealer.

Only use parts and attachments supplied or approved by your Bartell equipment manufacturer. The consequences of modifying the design of this equipment can include personal injury, equipment failure, and voiding your warranty. If you are unsure about a repair or an apparent malfunction, contact your Bartell dealer or the phone contacts at the bottom of each page of this manual.

Technical service bulletins, user's manual updates, and other information are posted on the Bartell website: <http://www.bartellglobal.com>. Check this website periodically for updates or other potentially useful information about your equipment.

Never use a Bartell Electric Generator in an enclosed space with poor air flow, such as a basement or small room. The gasoline engine produces, among other things, toxic carbon monoxide gas. Without proper ventilation, this gas will build up and cause health effects such as organ damage and death to anyone in the vicinity.

Never operate the Bartell Electric Generator in a wet environment.

Never connect the Bartell Electric Generator to a power circuit if the commercial power supply is not disconnected.

Always keep 3 ft. (1m) away from flammable materials. The Generator operator should always be lucid and aware of his/her surroundings.

Never operate the Generator while under the influence of drugs, alcohol, fatigue, sickness, hangover, extreme depression, emotional distraction, or medications/substances that may affect motor skills or judgment.

Always wear the appropriate personal protective equipment (PPE) while operating a Bartell Electric Generator. This includes (but is not limited to) proper clothing, hearing protection and protective footwear. Other safety gear may be job-site appropriate. Never leave the equipment unattended while running.

Safety

Always ensure that the operators have been properly trained prior to using the equipment. Children and small animals should never be present in the work area during operation of a Bartell Electric Generator.

Always check your Bartell Electric Generator for loose or missing nuts and bolts before starting. Tighten any loose fasteners and replace missing or broken parts.

Perform all routine maintenance as described within this manual. Failure to do so will void your warranty and will eventually result in premature equipment failure.

Never perform maintenance on a running piece of equipment. Shut down the engine and allow it to cool before servicing a Bartell Electric Generator, including mechanical work or lubrication.

Always replace missing, damaged, or unclear safety labels to ensure operator awareness and safety.

Never operate a Bartell Electric Generator with missing or damaged safety guards. Replace immediately with appropriate Bartell parts.

Never wear loose fitting clothing or jewelry around rotating equipment as it may become entangled in the machinery, resulting in serious injury.

Never fuel a Bartell Electric Generator while the engine is running. Ensure the engine has cooled sufficiently before refueling to avoid igniting gasoline fumes.

Always refuel a Bartell Electric Generator in a well-ventilated area, away from ignition sources such as sparks, flames, and lit cigarettes. Smoking while fueling the equipment may result in explosion.

Never operate a Bartell Electric Generator in explosive environments such as those where paint fumes, methane, natural gas, fine particulate, aerosol propellant, or solvent fumes are present.

Never smoke near a Bartell Electric Generator as stray gasoline fumes may ignite. Operating a Bartell Electric Generator around an open flame may also result in explosion.

Always shut down the engine and allow it to cool before lifting or transporting a Bartell Electric Generator.

Always tie down a Bartell Electric Generator when being transported in a truck or on a flatbed.

Empty the fuel tank if transporting over long distances.

Parts and Components Introduction - BG2800, BG5000, BG7000E

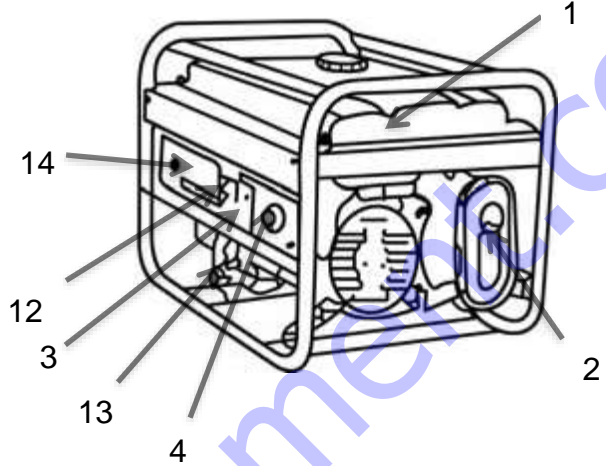
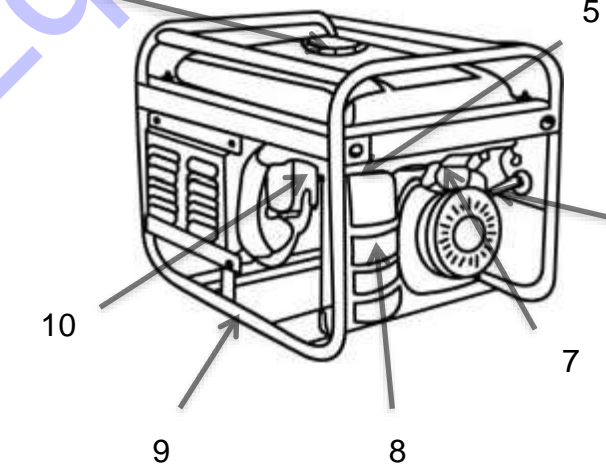
<ol style="list-style-type: none">1. Fuel tank2. Muffler3. Earth terminal4. AC socket/plug5. Choke lever6. Recoil Starter handle7. Fuel valve8. Air cleaner9. Frame10. Spark plug11. Fuel tank cap12. Breaker13. Oil gauge Dipstick14. Starter switch (BG7000E)15. AC Protector (not shown)	 <p>A line drawing of a portable generator from a front-three-quarter perspective. Numbered callouts point to various components: 1 (Fuel tank), 2 (Muffler), 3 (Earth terminal), 4 (AC socket/plug), 5 (Choke lever), 6 (Recoil Starter handle), 7 (Fuel valve), 8 (Air cleaner), 9 (Frame), 10 (Spark plug), 11 (Fuel tank cap), 12 (Breaker), 13 (Oil gauge Dipstick), and 14 (Starter switch).</p>
	 <p>A line drawing of the same portable generator from a rear-three-quarter perspective. Numbered callouts point to: 5 (Choke lever), 6 (Recoil Starter handle), 7 (Fuel valve), 8 (Air cleaner), 9 (Frame), 10 (Spark plug), and 11 (Fuel tank cap).</p>

Inspection - BG2800, BG5000, BG7000E

Engine Oil

1. Always check the oil level on a flat surface before starting.
2. Turn out the oil dipstick, and wipe it with a clean cloth.
3. Insert the dipstick back without screwing in, pull it out, and check the level.
4. In the case that the oil is low, refill it until the levels reach the upper mark on the dipstick.
5. Reinstall the dipstick when done.

Fuel

6. Open the fuel cap
7. Check the fuel levels and refill if necessary
8. Fill up to the shoulder of the fuel filter
9. Reinstall the fuel cap when complete

Air Cleaner

10. Loosen the clip and remove the air cleaner housing.
11. Separate the primary and secondary element.
12. Tap the elements or use compressed air to clear from air cleaner.
13. If required, squeeze excessive oil and wash air cleaner.
14. Reinstall elements, and attach to air cleaner housing.

Starting the Generator - BG2800, BG5000, BG7000E

1. Remove all loads from any power sockets and switch off the main breaker.
2. Set the fuel valve to the “On” position.
3. Push the choke lever to the “Close” (left) position.
4. Turn the engine or key switch to the “On” position.
5. The BG7000E is an electric start model. Continue to turn the key to “Start” and release when the generator starts. If the battery is too weak to start, the recoil start may be used. Pull out the recoil starter handle until resistance is felt, then pull it out swiftly from its original position.
6. Once the generator starts, gradually slide the choke lever to the right for “OPEN” position

Stopping the Generator - BG2800, BG5000, BG7000E

1. Turn off the breaker
2. Turn off the engine switch
3. Close the fuel valve
4. In case of emergency, turn the engine switch to “Off” to stop the generator.

**Never stop the generator at high speeds under a heavy load.
This can result in significant damage to the generator.**

Electrical Connections - BG2800, BG5000, BG7000E

Caution: To keep the generator in the best running condition and for electrical safety, please refer to the following:

Generator Grounding

Ground the generator to prevent electrical shock.

Typical Electrical Consumption

Type	Wattage		Appliance	Sample		
	Starting	Rated		Appliance	Starting	Rated
Electric Bulb or Heater	X1	X1	Electric Bulb TV	Electric Bulb 100w	100VA(W)	100VA(W)
Daylight Lamp	X2	X1.5	Daylight Lamp	Fluorescent Lamp 40w	80VA(W)	60VA(W)
Motor Drive	X3-5	X2	Refrigerator Electric Fan	Refrigerator 750w	450-750VA	300VAW

Appliance Start Up

If the generator is to supply power to more than two appliances, start them one by one with the highest current first.

Caution:

Never connect the generator to a home power circuit without a transfer switch. A transfer switch is required by the National Electric Code for any connection of power to a home.

A transfer switch prevents back-feed, which occurs when power goes back down the utility lines. Back-feed has the potential to cause a fire and can damage to the generator. Even worse, back-feed can electrocute any technicians working on the lines, causing injury or even death.

AC Application

1. Start the generator
2. Connect the appliances
3. Turn on the main breaker

DC Application

15. The DC terminal may be used for charging 12V automotive-type batteries only.
16. When using automotive-type batteries with cables, be sure to disconnect the negative cable from the battery before charging.
17. Connect the charging cable to the battery terminals and the DC terminal of the generator.
18. Connect the positive battery terminal to the positive generator terminal.
19. Do not reverse the charging cables, or serious damage to the generator and/or battery may occur.
20. Do not allow the free ends of the cables to touch, as it can short circuit the battery.
21. When a large capacity battery is charged, excessive current flows (depending on the discharge condition), can cause the fuse for the DC current to burn out.
22. Batteries produce explosive gases. Keep sparks flames and cigarettes well away.
23. To prevent the possibility of creating a spark near the battery, always connecting charging cables to the battery first and then only to the generator. When disconnecting, remove the cables at the generator end first.
24. Charge the battery in a well-ventilated place.
25. Before charging, remove the cap from each cell of the battery. Discontinue charging if the electrolyte temperature exceeds 45C.

Regular Inspection and Maintenance - BG2800, BG5000, BG7000E

Daily and regular inspection is important to ensure safe, proper, and long term operation of the generator. Refer to the provided regular inspection table when conducting an inspection and maintenance.

Inspection and Maintenance Table	Daily Check	20 Hrs or First Month	50 Hrs or Every 3 Months	100 Hrs or every 6 Months	300 Hrs or every year	Refer Page
Engine Oil Check	Inspect	Replace		Replace		
Air Cleaner Check (1)	Inspect					
Air Cleaner Wash (1)			Clean			
Fuel Sediment Cup				Clean		
Fuel Filter	Inspect			Clean		
Spark Plug				Clean		
Valve Clearance (2)					Check-adjust	
Combustion Chamber (2)					Clean	
Fuel Tank Wash	Every 2 years or when necessary					

(1) Service more frequently in dusty areas

(2) These items should be serviced by your servicing dealer, unless you have the proper tools and are mechanically proficient.

Engine Oil Replacement

1. Loosen the oil drain plug.
2. Drain the oil and remove the dipstick.
3. Screw on and tighten the drain plug with seal washer.
4. Reinstall the dipstick.

Recommended Engine Oil: 4-stroke gasoline engine oil API Service Classification SAE 10W-30 equivalent to SJ or better.

In Frigid Temperature (below -15C): 4-stroke gasoline engine oil API Service Classification SAE 5W-30 equivalent to SJ or better.

Spark Plug Cleaning

1. Remove the spark plug cap.
2. Remove the spark plug.
3. Clean (e.g. wire brush) away the carbon build up
4. Measure and adjust the electrode clearance/gap (0.7-0.8mm).
5. Reinstall the spark plug and cap.

Storage - BG2800, BG5000, BG7000E

Storage Preparation

Proper storage preparation is essential for keeping your engine trouble-free and looking good. The following steps will help to keep rust and corrosion from impairing your engine's function and appearance, and will make the engine easier to start when you use it again.

Cleaning

If the engine has been running, allow it to cool for at least half an hour before cleaning. Clean all exterior surfaces, touch up any damaged paint, and coat other areas that may rust with a light film of oil.

Using a garden hose or pressure washing equipment can force water into the air cleaner or muffler opening. Water in the air cleaner will soak the air filter, and water that passes through the air filter or muffler can enter the cylinder, causing damage.

Fuel

Gasoline will oxidize and deteriorate in storage. Deteriorated gasoline will cause hard starting, and it leaves gum deposits that clog the fuel system. If the gasoline in your engine deteriorates during storage, you may need to have the carburetor and other fuel system components serviced or replaced.

The length of time that gasoline can be left in your fuel tank and carburetor without causing functional problems will vary with such factors as gasoline blend, your storage temperatures, and whether the fuel tank is partially or completely filled. The air in a partially filled fuel tank promotes fuel deterioration. Very warm storage temperatures accelerate fuel deterioration. Fuel deterioration problems may occur within a few months, or even less if the gasoline was not fresh when you filled the fuel tank.

Fuel system damage or engine performance problems resulting from neglected storage preparation are not covered under the Distributor's Limited Warranty.

Depending on the region where you operate your equipment, fuel formulations may deteriorate and oxidize rapidly. Fuel deterioration and oxidation can occur in as little as 30 days and may cause damage to the carburetor and/or fuel system. Please check with your servicing dealer for local storage recommendations.

Draining the Fuel Tank and Carburetor

1. Move the fuel valve lever to the OFF position.
2. Place an approved gasoline container below the carburetor, and use a funnel to avoid spilling. Remove the carburetor drain bolt and gasket.
3. Remove the sediment cup and O-ring, then move the fuel valve lever to the ON position.
4. After all the fuel has drained into the container, reinstall the drain bolt, gasket, sediment cup and O-ring. Tighten the drain bolt and sediment cup securely.

Engine Oil

1. Change the engine oil (see page 15)
2. Remove the spark plug (see page 15).
3. Pour one to two teaspoons (5-10 cc) of clean engine oil into the cylinder.
4. Pull the starter rope several times to distribute the oil in the cylinder.
5. Reinstall the spark plug.
6. Pull the starter rope slowly until resistance is felt and the notch on the start pulley aligns with the hole at the top of the recoil starter cover. This will close the valves so moisture cannot enter the engine cylinder. Return the starter rope gently.

Storage Precautions

If your engine will be stored with gasoline in the fuel tank and carburetor, it is important to reduce the hazard of gasoline vapor ignition. Select a well-ventilated storage area away from any appliance that operates with a flame, such as a furnace, water heater, or clothes dryer. Also, avoid any area with a spark producing electric motor, or where power tools are operated.

If possible, avoid storage areas with high humidity, because that promotes rust and corrosion.

Keep the engine level in storage. Tilting can cause fuel or oil leakage.

With the engine and exhaust system cool, cover the engine to keep out dust. A hot engine and exhaust system can ignite or melt some materials. Do not use sheet plastic as a dust cover. A nonporous cover will trap moisture around the engine, promoting rust and corrosion.

If equipped with a battery for electric starter types, recharge the battery once a month while the engine is in storage. This will help to extend the service life of the battery.

Removal from Storage

Check your engine as described in the INSPECTION section of this manual.

If the fuel was drained during storage preparation, fill the tank with fresh gasoline. If you keep a container of gasoline for refueling, be sure it contains only fresh gasoline. Gasoline oxidizes and deteriorates over time, causing hard starting.

If the cylinder was coated with oil during storage preparation, the engine will smoke briefly at start up. This is normal.

Troubleshooting BG2800, BG5000, BG7000E

Starting Failure

1. Is the engine switch at the "ON" position?
2. Is the oil level too low?
3. Is there enough fuel?
4. Check the spark plug for spark during engine cranking.

Appliance Does Not Work

1. Check the appliance
2. Is the breaker in the "ON" position?
3. Is the fuse for the power outlet tripped?

Discount-Equipment.com

ELECTRICAL DIAGRAMS

BG2800

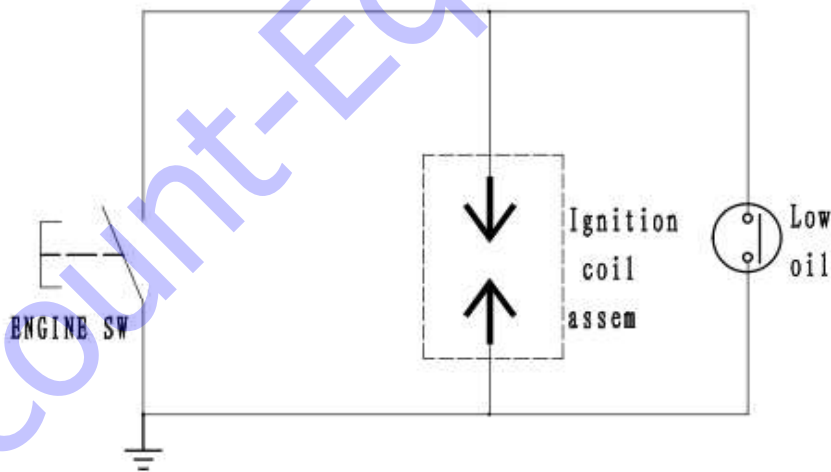
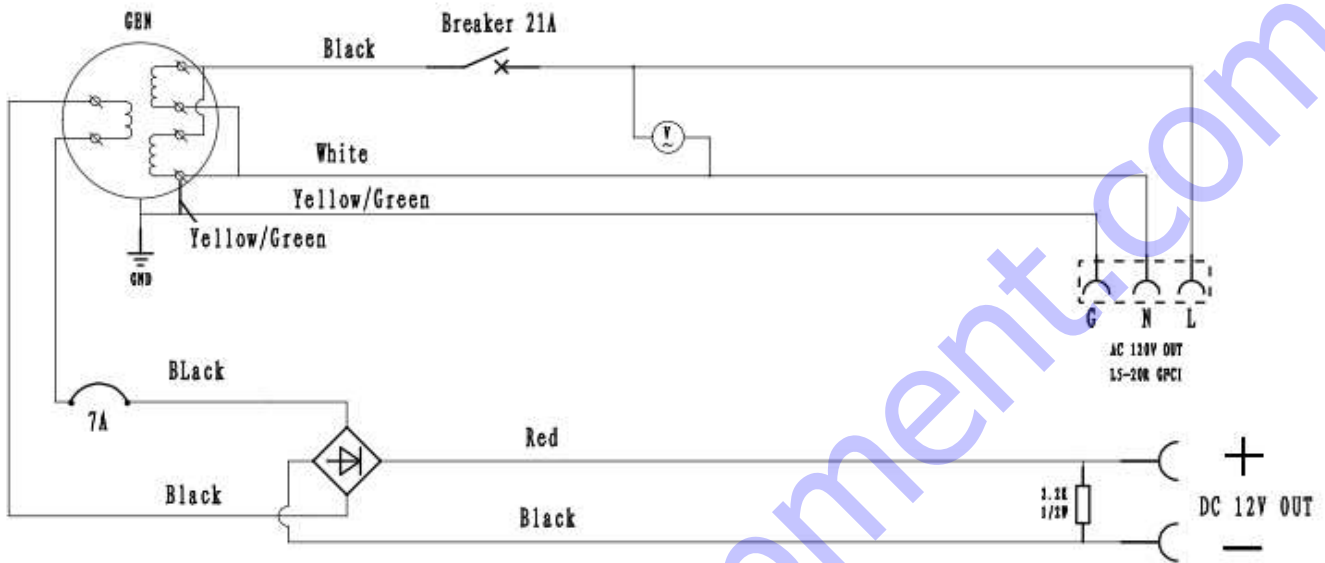

BG5000

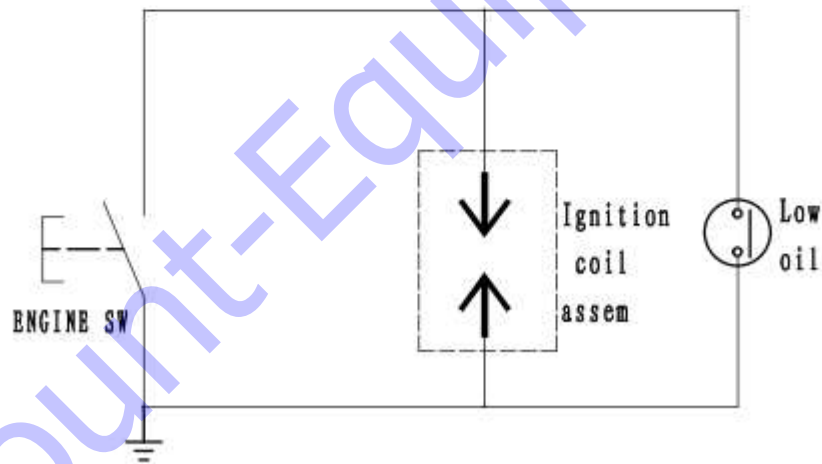
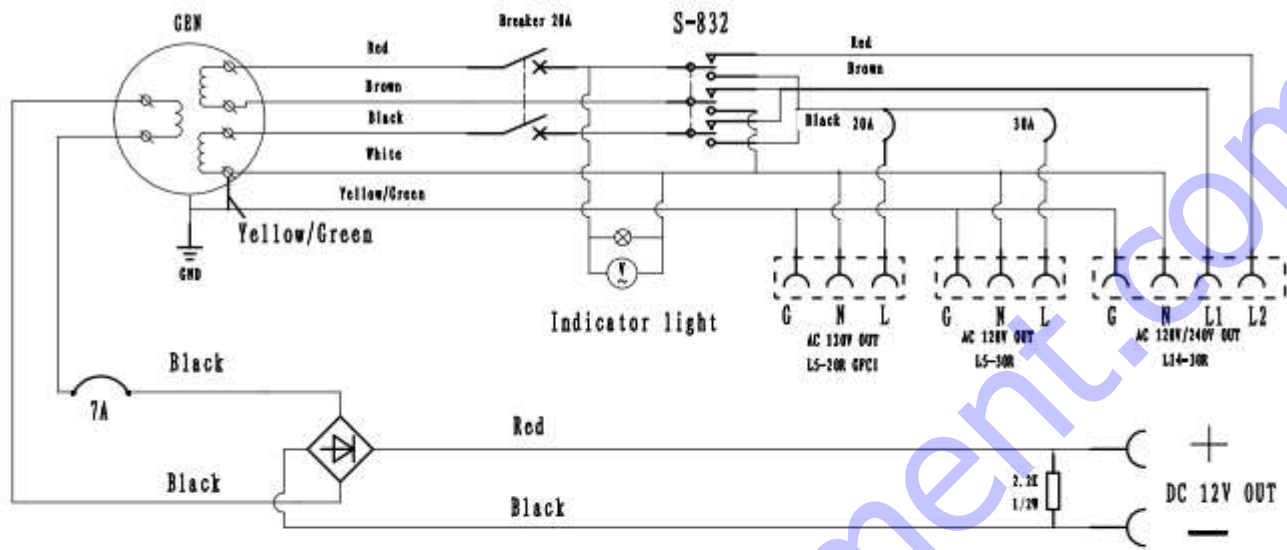

BG7000E

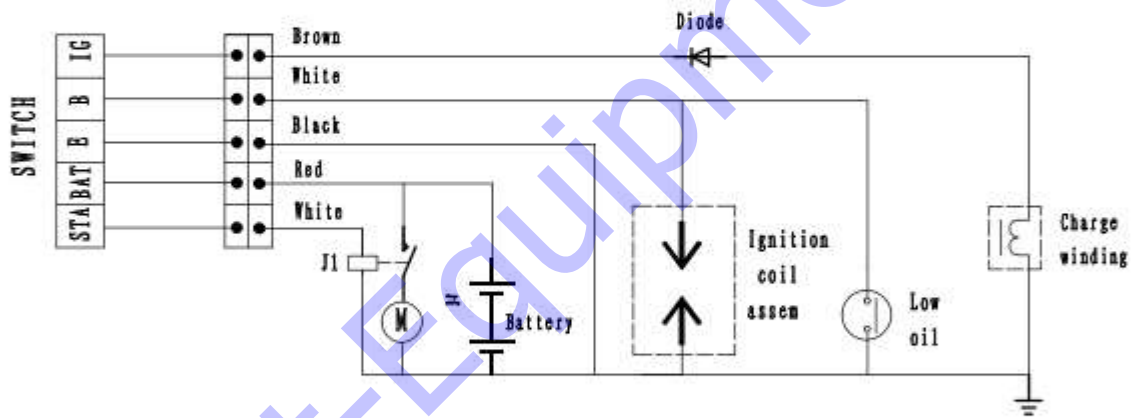
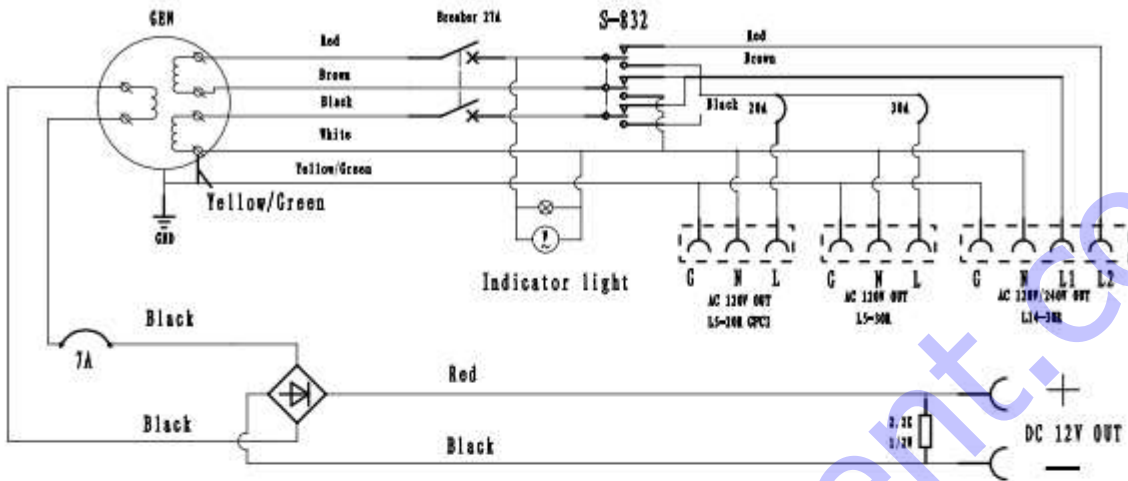

Key

	IG	BAT	STA	E	B
OFF				○ — ○	
ON	○ — ○				
START	○ — ○ — ○				



Assembly Drawings and Parts List

Discount-Equipment.com

Engine and Alternator

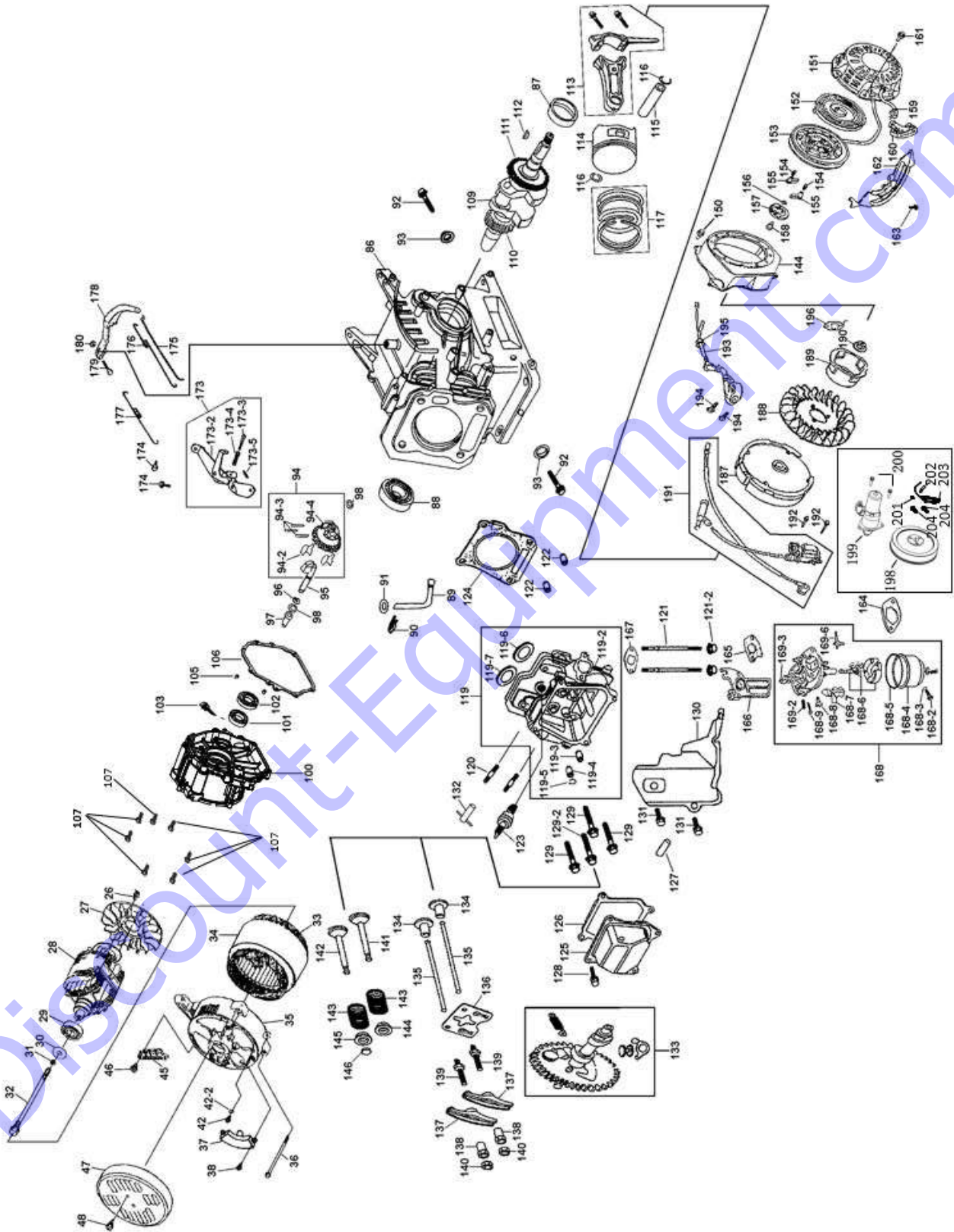

Frame, Muffler, Fuel Tank, and Air Cleaner

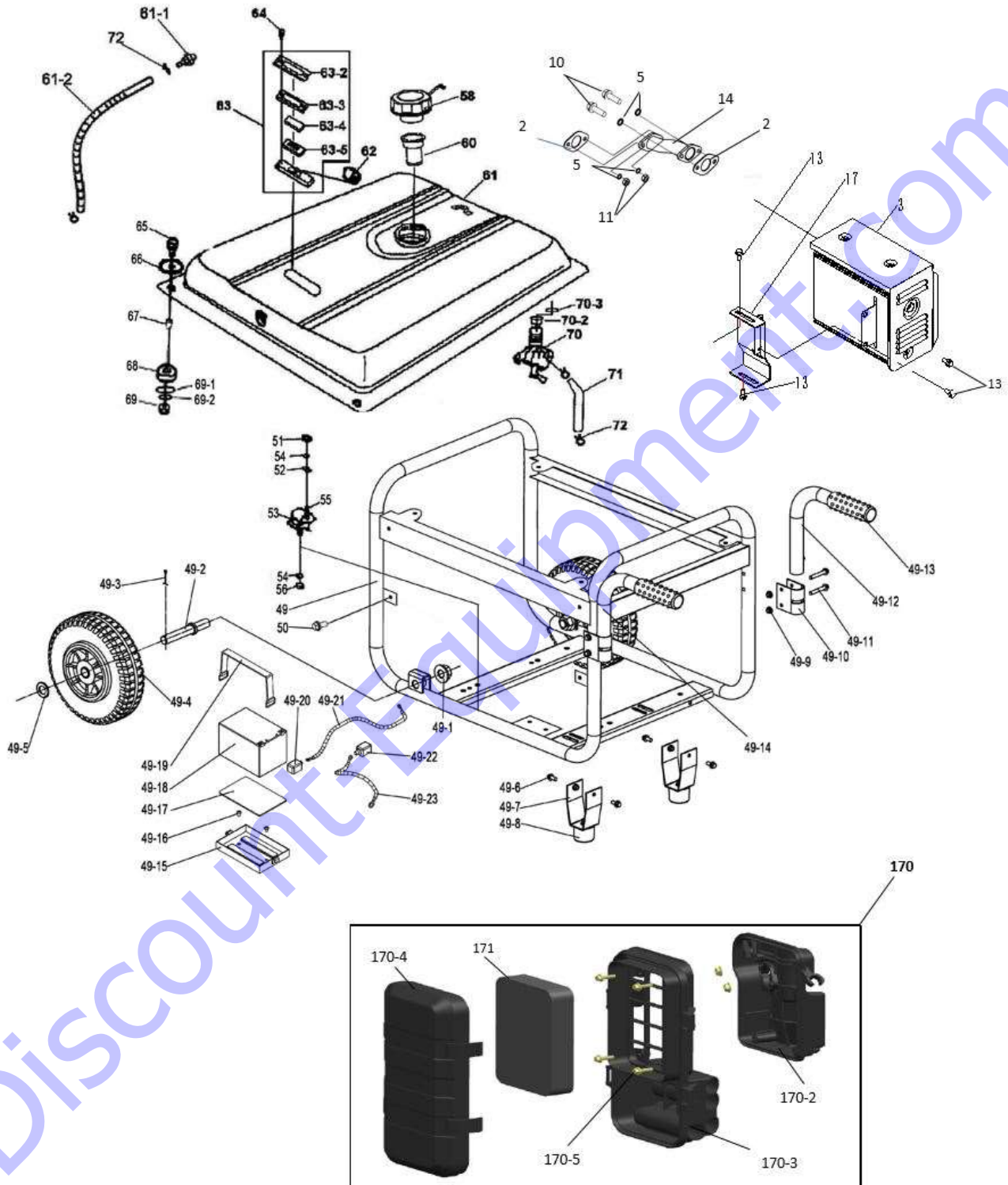

Control Panels

BG2800

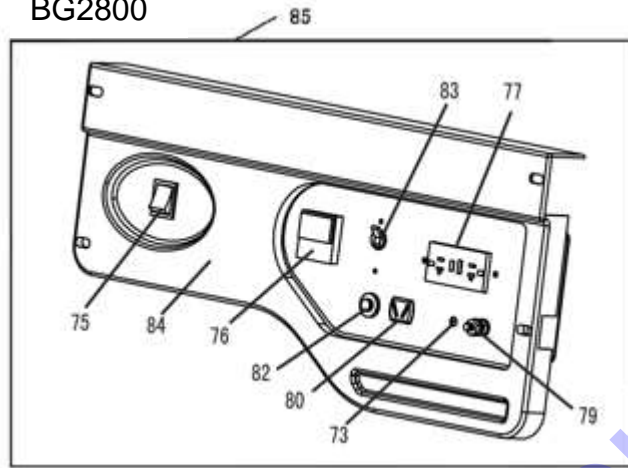

BG5000

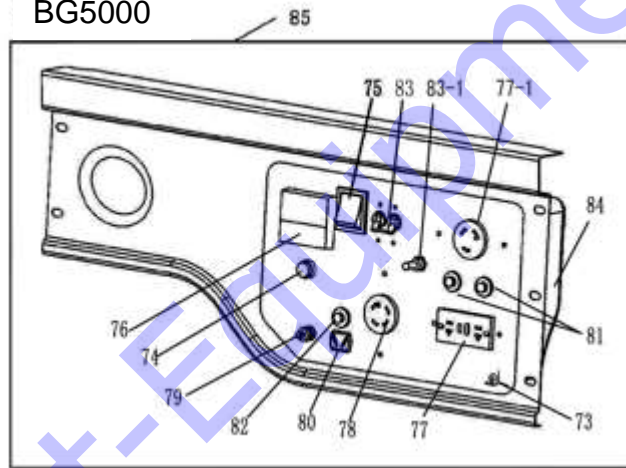

BG7000E

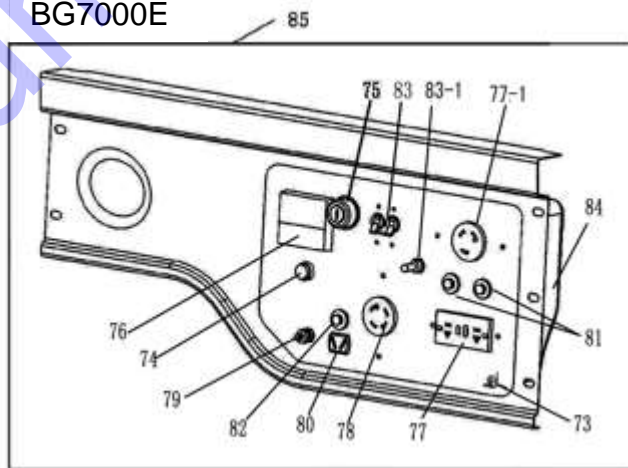

Parts List

Item No.	Part No.			Description	Qty.
	BG2800	BG5000	BG7000E		
2	25001001	38001001	38001001	Exhaust Gasket	2
3	25001100	38001101	38001101	Muffler Assembly	1
5	-	LMB08	LMB08	Flange HD Hex. Nut	4
10	-	LSB08025	LSB08025	Flange Head Bolt	2
11	Call Bartell	Call Bartell	Call Bartell	BOLT M8	2
13	LSB08016	LSB08016	LSB08016	Flange bolt M8x16	4
14	-	Call Bartell	Call Bartell	Exhaust Pipe	1
17	Call Bartell	Call Bartell	Call Bartell	Muffler Support	1-2 ^x
24-48	3000ALT	5000ALT	7500ALT	Alternator Assembly	1
26	-	LSB05012	LSB05012	Tapping Screw	2
27	25002002	38002002	38002002	Alternator Fan	1
28	30002100	50002100	65002100	Rotor	1
29	25002003	38002003	38002003	Ball Bearing	1
30	PDC08	PDC010	PDC010	Washer	1
31	TDA08	TDA10	TDA10	Lock Washer	1
32	LZA08230	LZA10250	LZA10265	Hex. Bolt	1
33	30002200	50002200	65002200	Stator Assembly	1
34	30002004	50002004	65002004	Stator Protector	1
35	25002005	28002005	28002005	Rear Cover	1
36	LSB06145	LSB06164	LSB06179	Flange HD Hex. Bolt	4
37	25002300	38002300	38002300	Capacitor	1
38	LSB05012	LSB05012	LSB05012	Flange HD Hex. bolt	2
42	LSB05012	LSB05012	LSB05012	Flange HD Hex. bolt	1
42-2	TD08	TD08	TD08	Lock Washer	1
45	25002400	38002400	38002400	Terminal Block	1
46	LSB05012	LSB05012	LSB05012	Flange HD Hex. Bolt	2
47	25002007	38002007	38002007	End Cover	1
48	LSB05012	LSB06012	LSB06012	Flange HD Hex. Bolt	2
49	25003100	38003100	38003100	Frame	1

49-1	425140001120	-	-	Locknut	2
49-2	306000112800	-	-	Axle	2
	-	69006	69006	Axle	
49-3	450025030230	12414	12414	Cotter Pin	2
49-4	306000200322	996699	996699	Wheel	2
49-5	431160000100	431160000100	431160000100	Washer	2
49-6	402060120160	402060120160	402060120160	Bolt	4
49-7	306000108508	306000108508	306000108508	Foot Mount	2
49-8	311020003700	311020003700	311020003700	Rubber Foot	2
49-9	422060000120	422060000120	422060000120	M6 Hex Nut	4-6 ^t
49-10	306000104908	306000106211	306000106211	Splint	2
49-11	411060350120	411060350120	411060350120	Screw	4
49-12	306290250204	306000109704	306000109704	Right Handle	1
49-13	306000100600	306000105800	306000105800	Handle Grip	2
49-14	306290250104	306000109604	306000109604	Left Handle	1
49-15*	-	-	306590250707	Battery Holder	1
49-16*	-	-	411060100120	Screw M6 x 10	2
49-17*	-	-	211065900100	Rubber Gasket	1
49-18*	-	-	306000300600	12AH Battery	1
49-19*	-	-	306140310200	Battery Fixer	1
49-20*	-	-	285061503000	Red Sheath	1
49-21*	-	-	285061504015	Red Battery Wire	1
49-22*	-	-	285061503001	Black Sheath	1
49-23*	-	-	285061504014	Black Battery Wire	1
50	LDA06012	LDA06012	LDA06012	Pan HD Screw	4
51	LMA08	LMA08	LMA08	Hex. Nut	4
52	PDA08	PDA08	PDA08	Washer	4
53	25003200A	25003200A	25003200A	Shock Absorber (engine)	2
53	25003200B	25003200B	25003200B	Shock Absorber (alternator)	2
54	TDA08	TDA08	TDA08	Lock Washer	8
55	LSB08045	LSB08045	LSB08045	Flange HD Hex. Bolt	2
56	LMA08	LMA08	LMA08	Flange HD Hex. Nut	4
58	25004001	25004001	25004001	Fuel Tank Cap (CARB Approved)	1
60	25004003	25004003	25004003	Fuel Strainer	1

61	25004100	38004100	38004100	Fuel Tank Assembly	1
61-1	Call Bartell	Call Bartell	Call Bartell	Joint Connection	1
61-2	Call Bartell	Call Bartell	Call Bartell	Fuel Line 4.5 x 8.5	600 mm
62	25004004	25004004	25004004	Fuel Lever	1
63	25004005	25004005	25004005	Fuel Level Indicator	1
63-2	-	-	-	Fuel Indicator Cover	1
63-3	-	-	-	Top Gasket Cover	1
63-4	-	-	-	Glass	1
63-5	-	-	-	Gasket for Glass	1
64	LDA05010	LDA05010	LDA05010	Countersunk HD Screw	2
65	LSB06012	LSB06012	LSB06012	Flange HD Hex. Bolt	4
66	PDB06	PDB06	PDB06	Washer	4
67	25004006	25004006	25004006	Collar	4
68	25004007	25004007	25004007	Rubber Grommet	4
69	LMA06	LMA06	LMA06	Hex. Nut	4
69-2	Call Bartell	Call Bartell	Call Bartell	Washer	4
69-3	Call Bartell	Call Bartell	Call Bartell	Lock Washer	4
70	25004200	25004200	25004200	Fuel Valve	1
70-2	-	-	-	Special Nut	1
70-3	-	-	-	Rubber Seal with Flange	1
71	25004008	38004008	38004008	Fuel Pipe	1
72	25004009	25004009	25004009	Clip	4
73	411050200120	418040160121	418040160121	Special Screw	2
74	-	5022001402201	5022001402201	Power Indicator Light	1
75	305215003101	305215003101	305432001061	Engine On/Off Switch	1
76	305169104301	305160045302	305160045302	Voltmeter	1
77	305031252000	305031252000	305031252000	120V Socket	1
77-1	-	305041253001	305041253001	120V/240V Socket	1
79	79	79	79	Ground Terminal (assembly with following parts)	1
	402060220260	402060220260	402060220260	Bolt	1

	422060000121	422060000121	422060000121	Nut	2
	431060000103	431060000103	431060000103	Washer	1
	432060000101	432060000101	432060000101	Spring Washer	1
	434060000201	434060000201	434060000201	Serrated Gasket	1
80	305130000602	305130000602	305130000602	DC socket	1
81	-	305200742001	305200742001	Current switch	2
82	305201120704	305201120704	305201120704	Fuse	1
83	305170530216	305170530205	305170530275	Circuit Breaker	1
83-1	-	305242503003	305424503003	Voltage Selection Switch	1
84	305495000105	305495001602	305495001602	Rear Control Panel Cover	1
85	2050118020002	2050118510004	2050118510005	Control Panel Assembly	1
86	20001001	39001001	39001001	Crankcase	1
87	YF254125	YF355208	YF355208	Oil Seal	1
88	ZCA6205	ZCA6207	ZCA6207	Ball Bearing	1
89	16001002	34001002	34001002	Governor Arm Shaft	1
90	16001003	24001003	24001003	Lock Pin	1
91	16001004	24001004	24001004	Washer	1
92	LSB10015	LSB12015	LSB12015	Drain Plug	2
93	16001005	24001005	24001005	Drain Plug Washer	2
94	16001100	34001100	34001100	Governor Kit	1
94-2	-	-	-	Governor Weight	2
94-3	-	-	-	Governor Weight Pins	2
94-4	-	-	-	Governor Gear	1
96	16001007	16001007	16001007	Governor Shaft Clip	1
97	16001008	24001008	24001008	Governor	1
98	16001004	16001004	16001004	Washer	2
100	16002001	34002001	34002001	Crankcase Cover	1
101	YF254125	YF355208	YF355208	Oil Seal	1
102	ZCA6205	ZCA6207	ZCA6207	Ball Bearing	1
103	16002002	24002002	24002002	Oil Filler Cap	2
104	16002003	16002003	16002003	Oil Filler Cap Gasket	2
105	XA0814	XA0814	XA0814	Sleeve	2

106	16002004	34002004	34002004	Case Cover Gasket	1
107	LSC080338	LSC080338	LSC080338	Flange HD Hex. Bolt	7
109	20003101	34003101	34003101	Crankshaft	1
110	16003102	34003102	34003102	Timing Driving Gear	1
111	16003103	34003103	34003103	Drive Gear	1
112	YJA0418	YJA0418	YJA0418	Woodruff Key	1
113	16003200	34003200	34003200	Complete Connecting Rod	1
114	20003004	39003004	39003004	Piston	1
115	16003005	34003005	34003005	Piston Pin	1
116	16003006	34003006	34003006	Piston Pin Clip	1
117	16003300	39003300	39003300	Piston Ring Set	1
119	20004100	34004100	34004100	Cylinder Head Assembly	1
119-2	20004101	34004101	34004101	Cylinder Head	1
119-3	16004102	34004102	34004102	Intake Valve Guide	1
119-4	16004103	24004103	24004103	Exhaust Valve Guide	1
119-5	16004104	24004104	24004104	Valve Guide Clip	2
119-6	16004105	34004105	34004105	Intake Valve Seat	1
119-7	16004106	34004106	34004106	Exhaust Valve Seat	1
120	LZA08020	LZA08032	LZA08032	Threaded Stud	2
121	16004007	34004007	34004007	Threaded Stud	2
122	XA1016	XA1220	XA1220	Sleeve	2
123	16004200	24004200	24004200	Spark Plug	1
124	16004001	39004001	39004001	Cylinder Head Gasket	1
125	16004300	24004300	24004300	Head Cover	1
126	16004002	24004002	24004002	Head Cover Gasket	1
128	LSB06012	LSB06012	LSB06012	Flange HD Hex. Bolt	4
129	16004004	24004004	24004004	Flange HD Hex. Bolt	3
129-2	16004004	24004004	24004004	Flange HD Hex. Bolt	1
130	16004005	34004005	34004005	Cover	1

131	LSB06012	LSB06012	LSB06012	Flange HD Hex. Bolt	2
133	20005100	39005100	39005100	Camshaft Assembly	1
134	20005001	24005001	24005001	Valve Lifter	2
135	16005002	34005002	34005002	Push Rod	2
136	16005003	24005003	24005003	Push Rod Guide Plate	1
137	16005201	24005201	24005201	Valve Rocker	2
138	16005203	16005203	16005203	Pivot Nut	2
139	16005202	16005202	16005202	Rocker Pivot Pin	2
140	16005204	16005204	16005204	Special Hex. Nut	2
141	16005004	34005004	34005004	Intake Valve	1
142	16005005	34005005	34005005	Exhaust Valve	1
143	16005006	24005006	24005006	Valve Spring	2
144	16005007	24005007	24005007	Intake Valve Spring Seat	1
145	16005008	24005008	24005008	Exhaust Valve Spring Seat	1
146	16005009	24005009	24005009	Valve Rotator	1
149	16006100	34006100	34006100	Fan Hood	1
150	LSB06012	LSB06012	LSB06012	Flange Head Hex. Bolt	4
151-160	16006200	34006200	34006200	Recoil Assembly	
151	16006201	34006201	34006201	Casing	1
152	16006202	34006202	34006202	Spiral Spring	1
153	16006203	34006203	34006203	Rope Reel	1
154	16006204	34006204	34006204	Ratchet Spring	2
155	16006205	34006205	34006205	Ratchet	2
156	16006206	34006206	34006206	Friction Spring	1
157	16006207	34006207	34006207	Spring Lid	1
158	16006208	34006208	34006208	Flanged Retainer Bolt	1
159	16006209	34006209	34006209	Starter Rope	1
160	16006210	34006210	34006210	Pull handle	1
161	LSB06008	LSB06010	LSB06010	Flange Head Hex. Bolt	3
162	16006001	34006001	34006001	Starter Shroud	1
163	LSB06012	LSB06012	LSB06012	Flange Head Hex Bolt	1

164	16007001	39007001	39007001	Air Cleaner Gasket	1
165	16007002	39007002	39007002	Carburetor Gasket	1
167	16007004	34007004	34007004	Inlet Gasket	1
168	20007200A	39007200A	39007200A	Carburetor Assembly	1
168-2	-	-	-	Float Chamber Drain Screw	2
168-3	-	-	-	Fiber Washer	2
168-4	-	-	-	Float Chamber	1
168-5	-	-	-	Float Chamber Gasket	1
168-6	-	-	-	Float	1
168-7	-	-	-	Choke Butterfly	1
168-9	-	-	-	Mixture Adjustment Screw	1
169-2	-	-	-	Spring for Mixture Adjustment	1
169-3	-	-	-	Throttle Unit	1
169-6	-	-	-	Choke Switch	1
170	16008200	34008200	34008200	Air Filter Assembly	1
170-2	-	-	-	Air Filter Housing	1
170-3	-	-	-	Filter Element Housing	1
170-4	-	-	-	Air Filter Cover	1
170-5	-	-	-	Flange HD Hex. Bolt	4
170-6	-	-	-	Air Filter Clamps	2
170-7	-	-	-	Air Filter Housing Seal	1
171	16008202	24008202	24008202	Air Filter Element	1
173	16009200	34009200	34009200	Speed Control Assembly	1
173-3	-	-	-	Pan Head Screw	1
173-4	-	-	-	Control Adjust Spring	1
173-5	-	-	-	Control Pull Spring	1
174	LSB06012	LSB06012	LSB06012	Flange HD Hex. Bolt	2
175	16009001	34009001	34009001	Governor Rod	1
176	16009002	34009002	34009002	Throttle Return Spring	1

177	16009003	34009003	34009003	Governor Spring	1
179	16009005	16009005	16009005	Governor Arm Bolt	1
180	LMB06	LMB06	LMB06	Flange Bolt	1
187	16012100	34012100	34012100	Fly Wheel	1
188	16012001	34012001	34012001	Cooling Fan	1
189	16012002	34012002	34012002	Starter Pulley	1
190	16012003	24012003	24012003	Fly Wheel Nut	1
191	16012004	34012004	34012004	Ignition Coil	1
192	LSB06028	LSB06028	LSB06028	Flange HD Hex. Bolt	2
193	16012005	24012005	24012005	Oil Sensor	1
194	LSB06014	LSB06014	LSB06014	Flange HD Hex. Bolt	2
195	LMB10	LMB10	LMB10	Special Nut	1
196	16012007	16012007	16012007	Diode	1
197	KBPC3506	KBPC3506	KBPC3506	Diode Bridge	1
	30001000	39001000	42001000	Engine	1
198	-	-	34012100E	Flywheel Component - Electric Type	1
199	-	-	34012400	Starter Motor Assembly	1
200	-	-	XA810	Dowel Pin	2
201	-	-	Call Bartell	Bolt M6 x 8	1
202	-	-	Call Bartell	Pressure Plate	1
203	-	-	Call Bartell	Charging Coil	1
204	-	-	Call Bartell	Bolt M6 x 30	2

*BG5000/BG7000E Qty. 1, BG2800 Qty. 2.

†BG5000/BG7000E Qty. 4, BG2800 Qty. 6

Discount Equipment

Discount-Equipment.com is your online resource for commercial and industrial quality parts and equipment sales.

Locations:

Florida (West Palm Beach): [561-964-4949](tel:561-964-4949)

Outside Florida TOLL FREE: [877-690-3101](tel:877-690-3101)

Need parts? Check out our website at www.discount-equipment.com

Can't find what you need?

Click on this link: <http://www.discount-equipment.com/category/5443-parts/> and fill out the request form.

Please have the machine model and serial number available in order to help us get you the correct parts. One of our experienced staff members will get back to you with a quote for the right part that your machine needs.

We sell worldwide for the brands: Genie, Terex, JLG, MultiQuip, Mayco, Toro/Stone, Diamond Products, Magnum, Airman, Mustang, Power Blanket, Nifty Lift, Atlas Copco, Chicago Pneumatic, Allmand Brothers, Essick, Miller Spreader, Skyjack, Lull, Skytrak, Tsurumi, Husquvarna/Target, Whiteman-Concrete/Mortar, Stow-Concrete/Mortar, Baldor, Wacker, Sakai, Snorkel, Upright, Mi-T-M, Sullair, Neal, Basic, Dynapac, MBW, Weber, Bartell, Bennar Newman, Haulotte, Ditch Runner, Blaw-Knox, Himoina, Best, Buddy, Crown, Edco, Wyco, Bomag, Laymor, Terremite, Barreto, EZ Trench, Takeuchi, Basic, Bil-Jax, Curtis, Gehl, Heli, Honda, ICS/PowerGrit, Puckett, Waldon, ASV, IHI, Partner, Imer, Clipper, MMD, Koshin, Rice, Gorman Rupp, CH&E, Cat Pumps, Comet, General Pump, Giant, AMida, Coleman, NAC, Gradall, Square Shooter, Kent, Stanley, Tamco, Toku, Hatz, Kohler, Robin, Wisconsin, Northrock, Oztec, Toker TK, Rol-Air, Small Line, Wanco, Yanmar



This page is intentionally left blank

Discount-Equipment.com