

Technical Information

23.2005

STIHL Special Tools

Contents

1. Testing Tool Kit
2. Pump
3. Summary

1. Testing Tool Kit

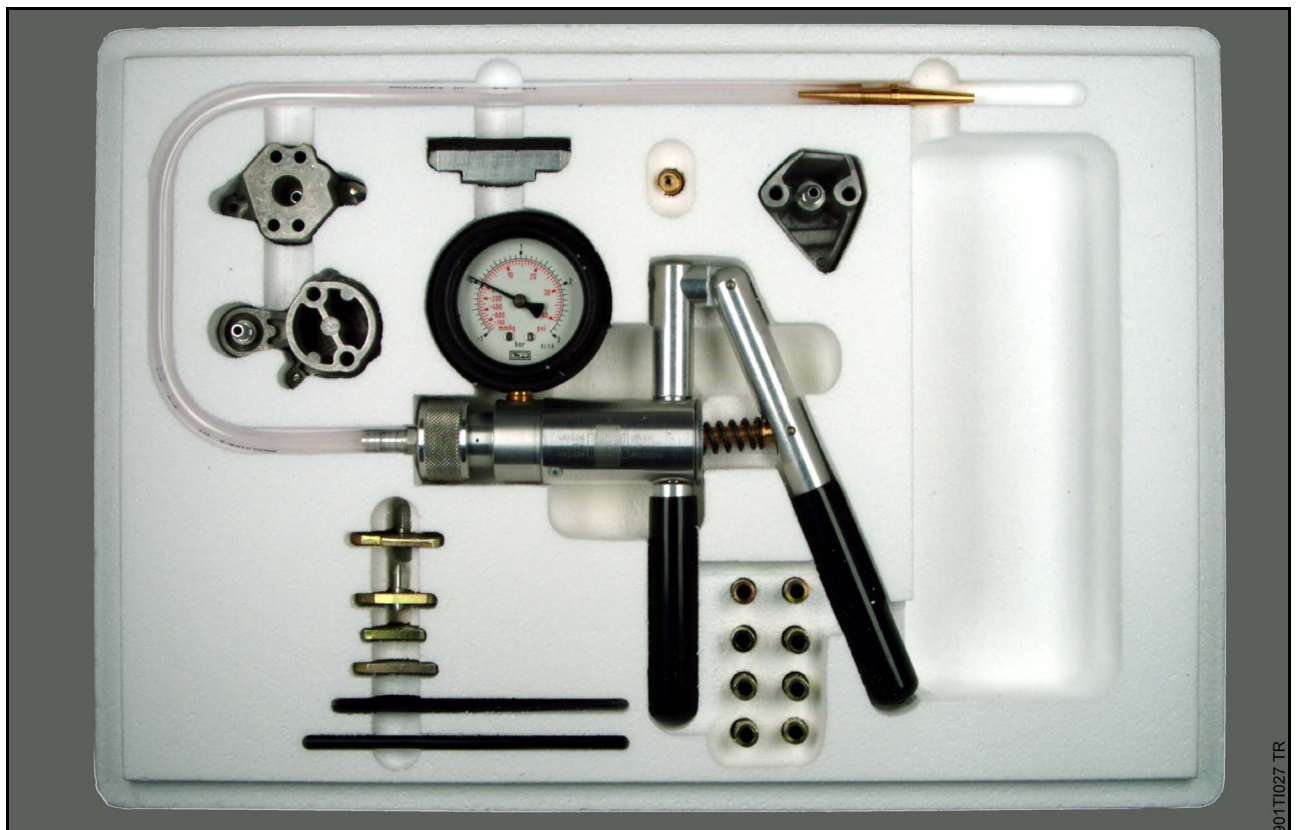

A new STIHL Testing Tool Kit 0000 890 1701 will be made available in the future. The new Testing Tool Kit supersedes the previous Testing Tool Kit 0000 890 1711.

The new kit has been enlarged to include testing tools for the model series currently on the market. Testing tools which are no longer current have been deleted from the new kit.

The crankcase tester 1106 850 2905 and the vacuum pump 0000 850 3501 which were contained in the previous Testing Tool Kit are now replaced by the pump 0000 850 1300 (see section 2).

2. Pump

The crankcase tester 1106 850 2905 and the vacuum pump 0000 850 3501 are replaced by the new pump 0000 850 1300.

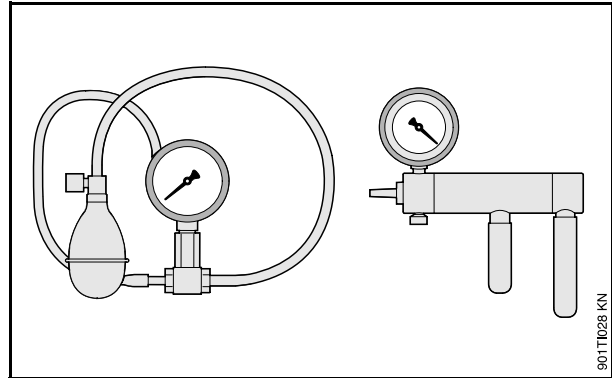

Left: Crankcase tester 1106 850 2905

Right: Vacuum pump 0000 850 3501

The new pump 0000 850 1300 combines the functions of the previous vacuum pump 0000 850 3501 (vacuum test) and previous crankcase tester 1106 850 2905 (pressure test).

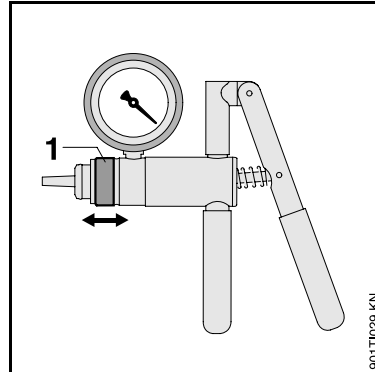

New pump 0000 850 1300

- Pressure test – slide ring (1) to the right
- Vacuum test – slide ring (1) to the left

3. Summary

Item	Part name	Previous	New	Remarks
Testing Tool Kit				
1	Testing Tool Kit; including Items 3-21, 26, 27	0000 890 1711	---	1)
2	Testing Tool Kit; including Items 3-14, 22-24, 25	---	0000 890 1701	
3	Flange	1106 850 4201	1106 850 4201	
4	Connector	0000 855 9200	0000 855 9200	
5	Bushing	0000 963 1008	0000 855 9200	
6	Flange	1128 850 4200	1128 850 4200	
7	Flange	1118 850 4200	1118 850 4200	
8	Sealing plate	0000 855 8106	0000 855 8106	
9	Flange	1119 850 4201	1119 850 4201	
10	Bushing	1124 893 7100	1124 893 7100	
11	Hose	1110 141 8600	1110 141 8600	
12	Sleeve	1123 851 8300	1123 851 8300	
13	Flange	1123 855 4200	1123 855 4200	
14	Sleeve	1127 851 8300	1127 851 8300	
15	Sealing plate	1120 855 8105	---	2)
16	Sealing plate	1120 855 8100	---	2)
17	Flange	1120 855 4200	---	2)
18	Flange	1110 850 4200	---	2)
19	Flange	1111 850 4200	---	2)
20	Flange	1111 850 4205	---	2)
21	Flange	1120 850 4201	---	2)
22	Flange	---	1124 850 4205	
23	Flange	---	4224 890 1200	
24	Flange	---	4224 893 2501	
Pump				
25	Pump	---	0000 850 1300	
26	Crankcase tester	1106 850 2905	---	1)
27	Vacuum pump	0000 850 3501	---	1)

Remarks

- 1) Previous version of part only remains available from factory while stocks last
- 2) Part remains available

Last Technical Information on the STIHL Special Tools: 47.2004